

® ADEMCO

5804BD BI-DIRECTIONAL WIRELESS KEY

INSTALLATION INSTRUCTIONS

General Information

The 5804BD is a four-button wireless key that permits an alarm system to be controlled remotely. It is a two-way device, which means that it can send a command to the alarm system, such as to arm or disarm, as well as receive status back from the control. Status is indicated by two bi-color status LEDs and a piezoelectric sounder. Each button can be programmed for any zone response type by using the alarm system's transmitter "learn" mode. Typical use is for arming, disarming, panic, and output relay operation.

The 5804BD must be used in conjunction with a 5800TM (Transmitter Module) and 5881 RF Receiver. The unit is powered by 2 replaceable Lithium batteries designed to provide up to 2 years of life (see "To Install/Replace Batteries" for more information).

Loop Assignments:

- Button A =>Loop 3
- Button B =>Loop 2
- Button C =>Loop 4
- Button D =>Loop 1

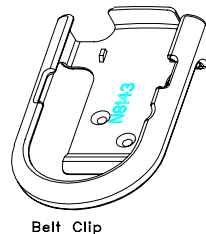
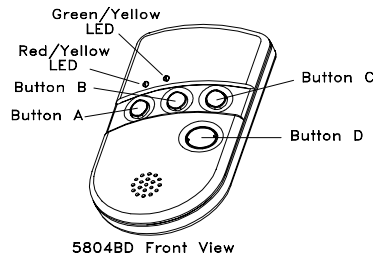

Note: Place the 5881 receiver and the 5800TM transmitter module in a high, centrally located area for best reception. The 5800TM module must be located between 1 and 2 feet from the receiver.

To Remove or Insert the Unit from Belt Clip

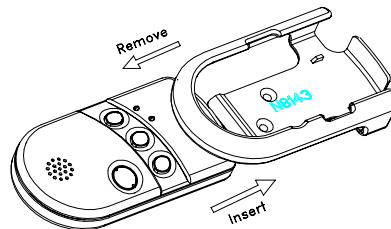

To Install/Replace Batteries

1. Remove the screw from the back case.
2. Remove case back by using the blade of a small screwdriver to pry open.
3. Place batteries in case back locations, see diagram. Use CR2430 or DL2430 Lithium battery only.
4. Close the case by snapping case front and back together.
5. Replace the screw to secure the case.

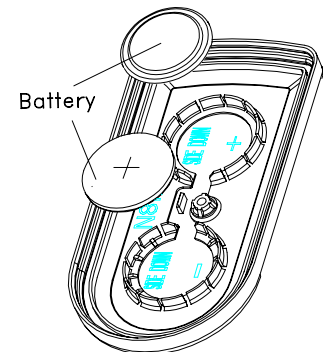

Improperly installing the batteries will cause damage to the batteries.

Programming the 5804BD House ID

You need to program a House ID number into the unit before you can use it to display the system status. **The House ID number must be same as the one used in the alarm control.** The House ID must be in the range of 01 to 31. The default in the 5804BD is 10.

To Enter a House ID

1. Enter House ID mode by pressing the “A”, “B” and “C” buttons at the same time until the Red and Green LEDs alternate flashing.
2. Enter the House ID number by using the “A” button to enter the 10’s digit and the “B” button to enter the 1’s digit. **Note:** If the entry is out of range (greater than 31), the unit will generate a long beep and discard the entry.
3. Accept the entry by pressing the “D” button.
4. The unit displays the stored number by flashing the left LED for the 10’s digit and flashing the right LED for the 1’s digit (for example, for House ID 21, the left LED will flash twice, the right LED will flash once).
5. The unit will then exit the House ID mode (a beep will be heard).

Example: To enter House ID # 17 into the unit:

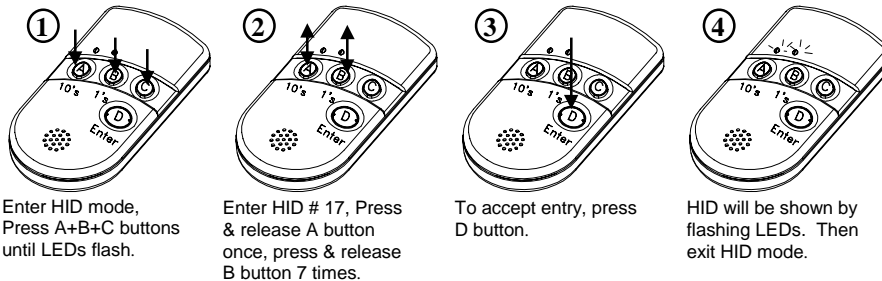

To View the House ID

- a) Enter House ID mode as described in step 1 (above).
- b) Depress the “D” button to view.
- c) The unit displays the stored number as described in step 4 (above).
- d) The unit will then exit House ID mode (a beep will be heard).

Programming a House ID in the Alarm Control

1. On Vista 40, 50, 50P, 100 and up, use Device Programming mode to enable the RF receiver and enter the House ID number.
2. On Via-30, Vista-20 and below, go to field *24 and enter the House ID number.

Programming the Buttons

Each 5804BD is assigned a unique serial number during manufacture. Each button on the unit also has a unique “loop” number that must be programmed into the alarm control during installation. Assign each button to an individual zone number and program the Input Type as “BR”--Button Type RF (entry of “5”) in the control’s Zone Programming mode. Then, input the serial number by one of the following methods:

- 1) “learn” the serial number of the device into the system as described in the alarm control’s Installation Instructions;
- 2) enter the serial number manually through the keypad;
- 3) serial number through VLINK downloading software.

Be sure to include the loop number of each button during programming (see loop assignments on previous page).

Button C

If you choose **not** to use the “C” button, you must do the following to avoid a “Check” condition when the button is accidentally pressed.:

1. Assign this button to a zone (see “Assign a Button to a Zone”).
2. After the serial number has been programmed, re-enter Zone Programming for that zone.
3. At the “Zone Type” prompt, enter 00 and press [*].
 - a) On Via-30 controls and below, the system will ask whether you want to permanently delete that zone. Enter 0 (No). This will cause the system to retain the serial number, but render the button inactive.
 - b) On Vista-40 and above, continue to press [*] until you see the “Enter zone No?” prompt again. At this point, Press 00 and [*]. Then press *99 to exit program mode.

Arm/Disarm Button

If a button assigned to a zone type 20 (Arm Stay), 21 (Arm Away) and 22 (Disarm), you must do the following:

On Vista 40, 50, 50P, 100 and up

You must assign a user to the button in order for it to operate.

To assign a user number to the Arm/Disarm button:

1. Enter [4 digit User Code] + [8] + [User #] + [4 digit new User Code]
2. Answer Yes or No on the "Open/Close Report ?" question.
3. Answer Yes on the "RF Button ?" question.
4. Enter the zone # assigned to the Arm/Disarm button.
5. Keypad shows the summary of user information on its display.
6. Test Arm/Disarm button to make sure it operates correctly.

On Via-30, Vista-20, and below

You do not have to assign a user to the button. The panel will report the zone number as the user number to the central station.

Operating the Buttons

To Activate a Button

To activate programmed function on a button, press and hold the button down until the yellow LED flashes (2 beeps will be heard), and then release it.

To Request System Status

Since the 5804BD is a two-way device, users can check the system status before arming or disarming their system. To check system status, press and release any button momentarily. The yellow LED will flash after you release the button (1 beep will be heard). After a second or two, the 5804BD will display the system status information using a combination of LED and sounder activity (see the System Status Indications Table, below). If 5804BD does not receive system status information from the panel for approximately five seconds, it will generate a long (1 second) beep and shut itself down. It will also shut itself down if there is no button activity within five seconds of receiving a status update.



This device may not receive the system status properly if it operates within a few feet of the 5881 RF receiver.

System Status Indications Table

LED	LED Condition	Sounder	System Status
Red	On Steady	2 Beeps	Armed Away or Maximum
	On Steady	3 Beeps	Armed Stay or Instant
	Flashing	Pulsing	Fire Alarm in progress
	Flashing	Steady	Armed, Burglary Alarm in progress
	Flashing	Silent	Alarm Memory
Green	On Steady	1 Beep	Disarmed, Ready to Arm
	Flashing	Silent	Disarmed, Not Ready to Arm
Yellow (right)	Flashing	Silent	Indicates RF transmission .
Red & Green	Alternately Flashing	Silent	In Enter House ID Mode
Green	Flashing	Pulsing	System in Trouble
	Flashing	Silent	System Not Ready

Multiple Button Operations

The 5804BD can generate the same responses as keypad panic key pairs of [*] + [#] and [*] + [1] by depressing "A" + "C" and "B" + "D" button pairs, respectively. You must depress the button pair for at least two seconds for the 5804BD to recognize the button pair command. These button pairs will allow the user to activate panic, fire, and medical alarms depending on control panel programming.

A+C Button Pair

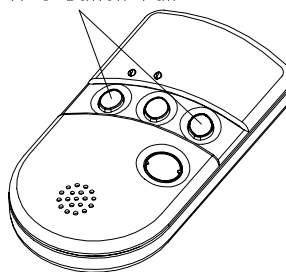

B+D Button Pair

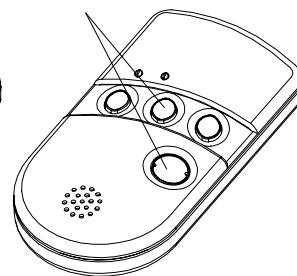

Low Battery Indication

When the unit goes into a Low Battery condition, the yellow LED will not flash when a button is pressed. Change both batteries immediately. Refer to instructions in "To Install/Replace Batteries" paragraph on first page.

Specifications

Physical:

Belt Clip: 4.1H x 2.2"W x 0.8"D
Transmitter: 3.9"H x 2.0"W x 0.69"D

Battery:

Maxell CR2430 or Duracell DL2430

REFER TO THE INSTALLATION INSTRUCTIONS FOR THE CONTROL WITH WHICH THIS DEVICE IS USED FOR LIMITATIONS OF THE ENTIRE ALARM SYSTEM.

FCC STATEMENT

This device complies with Part 15 of the FCC rules. Operation is subject to the following two conditions: (1) This device may not cause harmful interference, and (2) This device must accept any interference received, including interference that may cause undesired operation.

FCC ID: CFS8DL5804BD

FEDERAL COMMUNICATIONS COMMISSION (FCC) Part 15 STATEMENT

This equipment has been tested to FCC requirements and has been found acceptable for use. The FCC requires the following statement for your information:

This equipment generates and uses radio frequency energy and if not installed and used properly, that is, in strict accordance with the manufacturer's instructions, may cause interference to radio and television reception. It has been type tested and found to comply with the limits for a Class B computing device in accordance with the specifications in Part 15 of FCC Rules, which are designed to provide reasonable protection against such interference in a residential installation. However, there is no guarantee that interference will not occur in a particular installation. If this equipment does cause interference to radio or television reception, which can be determined by turning the equipment off and on, the user is encouraged to try to correct the interference by one or more of the following measures:

- If using an indoor antenna, have a quality outdoor antenna installed.
- Reorient the receiving antenna until interference is reduced or eliminated.
- Move the radio or television receiver away from the receiver/control.
- Move the antenna leads away from any wire runs to the receiver/control.
- Plug the receiver/control into a different outlet so that it and the radio or television receiver are on different branch circuits.

If necessary, the user should consult the dealer or an experienced radio/television technician for additional suggestions. The user or installer may find the following booklet prepared by the Federal Communications Commission helpful: "Interference Handbook"

This booklet is available from the U.S. Government Printing Office, Washington, DC 20402.

The user shall not make any changes or modifications to the equipment unless authorized by the Installation Instructions or User's Manual. Unauthorized changes or modifications could void the user's authority to operate the equipment.

ADEMCO LIMITED WARRANTY

Alarm Device Manufacturing Company, a Division of Pittway Corporation, and its divisions, subsidiaries and affiliates ("Seller"), 165 Eileen Way, Syosset, New York 11791, warrants its products to be in conformance with its own plans and specifications and to be free from defects in materials and workmanship under normal use and service for 24 months from the date stamp control on the product or, for products not having an Ademco date stamp, for 12 months from date of original purchase unless the installation instructions or catalog sets forth a shorter period, in which case the shorter period shall apply. Seller's obligation shall be limited to repairing or replacing, at its option, free of charge for materials or labor, any product which is proved not in compliance with Seller's specifications or proves defective in materials or workmanship under normal use and service. Seller shall have no obligation under this Limited Warranty or otherwise if the product is altered or improperly repaired or serviced by anyone other than Ademco factory service. For warranty service, return product transportation prepaid, to Ademco Factory Service, 165 Eileen Way, Syosset, New York 11791.

THERE ARE NO WARRANTIES, EXPRESS OR IMPLIED, OF MERCHANTABILITY, OR FITNESS FOR A PARTICULAR PURPOSE OR OTHERWISE, WHICH EXTEND BEYOND THE DESCRIPTION ON THE FACE HEREOF. IN NO CASE SHALL SELLER BE LIABLE TO ANYONE FOR ANY CONSEQUENTIAL OR INCIDENTAL DAMAGES FOR BREACH OF THIS OR ANY OTHER WARRANTY, EXPRESS OR IMPLIED, OR UPON ANY OTHER BASIS OF LIABILITY WHATSOEVER, EVEN IF THE LOSS OR DAMAGE IS CAUSED BY THE SELLER'S OWN NEGLIGENCE OR FAULT.

Seller does not represent that the products it sells may not be compromised or circumvented; that the products will prevent any personal injury or property loss by burglary, robbery, fire or otherwise; or that the products will in all cases provide adequate warning or protection. Customer understands that a properly installed and maintained alarm may only reduce the risk of a burglary, robbery, fire or other events occurring without providing an alarm, but it is not insurance or a guarantee that such will not occur or that there will be no personal injury or property loss as a result. CONSEQUENTLY, SELLER SHALL HAVE NO LIABILITY FOR ANY PERSONAL INJURY, PROPERTY DAMAGE OR OTHER LOSS BASED ON A CLAIM THE PRODUCT FAILED TO GIVE WARNING. HOWEVER, IF SELLER IS HELD LIABLE, WHETHER DIRECTLY OR INDIRECTLY, FOR ANY LOSS OR DAMAGE ARISING UNDER THIS LIMITED WARRANTY OR OTHERWISE, REGARDLESS OF CAUSE OR ORIGIN, SELLER'S MAXIMUM LIABILITY SHALL NOT IN ANY CASE EXCEED THE PURCHASE PRICE OF THE PRODUCT, WHICH SHALL BE THE COMPLETE AND EXCLUSIVE REMEDY AGAINST SELLER. This warranty replaces any previous warranties and is the only warranty made by Seller on this product. No increase or alteration, written or verbal, of the obligations of this Limited Warranty is authorized.

® ADEMCO

ALARM DEVICE MANUFACTURING CO.
A DIVISION OF PITTPWAY CORPORATION
165 Eileen Way, Syosset, NY 11791
COPYRIGHT © 1997 PITTPWAY CORPORATION